

## DATASHEET

# EkoFiber

EkoFiber is a hydraulically operated self-cleaning screen filter featuring a robust design and minimal maintenance requirements. The unit is designed to retain suspended solids and ensure continuous and reliable filtration. An integrated pre-filtration cartridge removes larger particles before they reach the main filtering element.

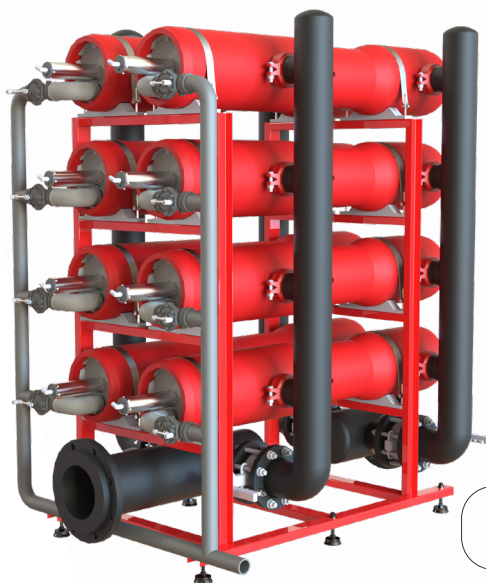

Modular skid configuration to increase flow capacity and filtration surface area

Backwashing pressure  
**35**  
psi

STANDARD  
**190**  
 $\mu\text{m}$

PRES  
**150**  
MAX  
psi

### SYSTEM

Filtration is achieved by retaining suspended solids as water passes through the screen openings. The system features a large filtration surface area, minimizing pressure loss during operation, and includes a pre-filter cartridge to intercept coarse debris. Filtration and self-cleaning processes are fully compatible and can operate simultaneously.

### MATERIALS FOR IRRIGATION

- Body:** fiberglass reinforced polyester (FRP)
- Gaskets:** synthetic rubber nitrile 60° Shore
- Screws:** zinc-plated corrosion-resistant for outdoor use
- Screen:** stainless steel cartridge + polyamide cartridge
- Suction scanner:** stainless steel AISI 316

### MATERIALS FOR INDUSTRIAL APPLICATIONS (FOOD GRADE)

- Body:** FRP (fiberglass reinforced polyester)
- Gaskets:** synthetic rubber nitrile 60° shore
- Screws:** super duplex steel
- Screen:** super duplex steel
- Suction scanner:** super duplex steel
- Temperature of the design:** 50° C. Please contact us about any other degree

### CLEANING

The screen cartridge is automatically cleaned by a set of suction nozzles that scan the entire screen surface, effectively removing accumulated particles during the backwashing cycle.

### INTERNAL AND EXTERNAL COATING

EkoFiber features a natural internal finish with a vinyl ester resin chemical barrier. Its external coating system consists of surface preparation, a two-component epoxy primer and an aliphatic acrylic polyurethane topcoat resistant to UV radiation and weather exposure, with an approximate total thickness of 150  $\mu\text{m}$ .

### FILTRATION ELEMENT

The stainless-steel screen is directly injected into a polyamide cartridge structure. The standard screen supplied with our automatic filters is 130  $\mu\text{m}$  (0.130 mm). Other filtration grades are available, ranging from 1.500  $\mu\text{m}$  (1.5 mm) down to 20  $\mu\text{m}$  (0.02 mm).

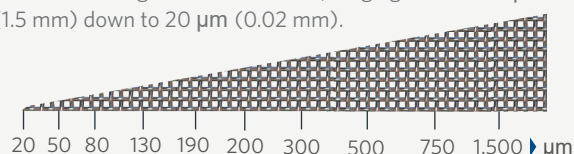

## AUTOMATIC HYDRAULIC EKOFIBER SCREEN FILTER

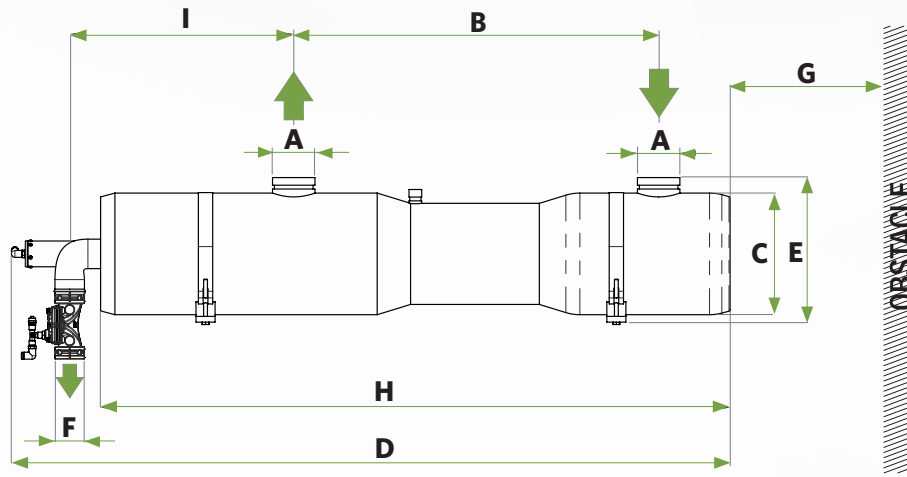

G\*: security area for removing the cartridge

### HEAD LOSS

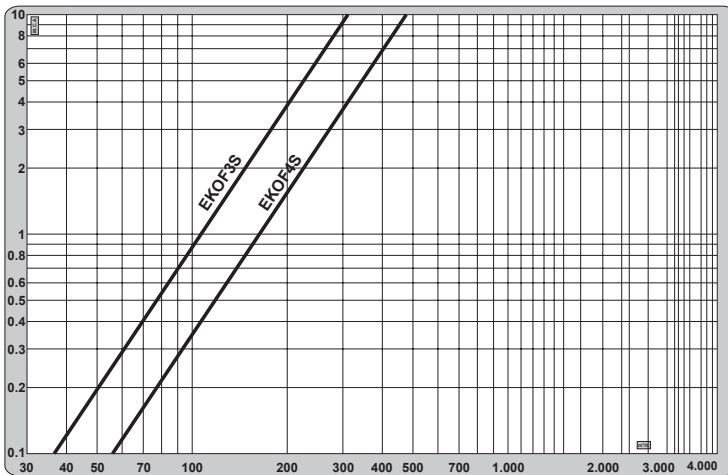

Results obtained in approved tests with clean water and 190 µm discs.



A (Ø)	B (mm)	C (mm)	D (mm)	E (mm)	F (Ø)	G (mm)	H (mm)	Net Weight (kg)	Package			Code
									Dimensions (mm)	Weight (kg)	Volume (m³)	
3"	765	255	1.507	305	1 ½" BSP F	750	1.320	72	1.550x420x530	82	0.345 m³	EKOF3S
4"	765	255	1.507	305	1 ½" BSP F	750	1.320	72	1.550x420x530	82	0.345 m³	EKOF4S

Maximum Recommended (m³/h)		Filtration Surface (cm²)	Screen Surface (cm²)	Backwashing			Cartridge Quantity	Code
< 50 ppm	50/100 ppm			Flow (m³/h)	Water Quantity (l)	Time		
70	37	4.136	3.185	12,4	69	20"	4 x T14P176	EKOF3S
105	57	4.136	3.185	12,4	69	20"	4 x T14P176	EKOF4S

\* For seawater application, the codes are EKOFW3S and EKOFW4S.

# AUTOMATIC HYDRAULIC EKOFIBER SCREEN FILTER

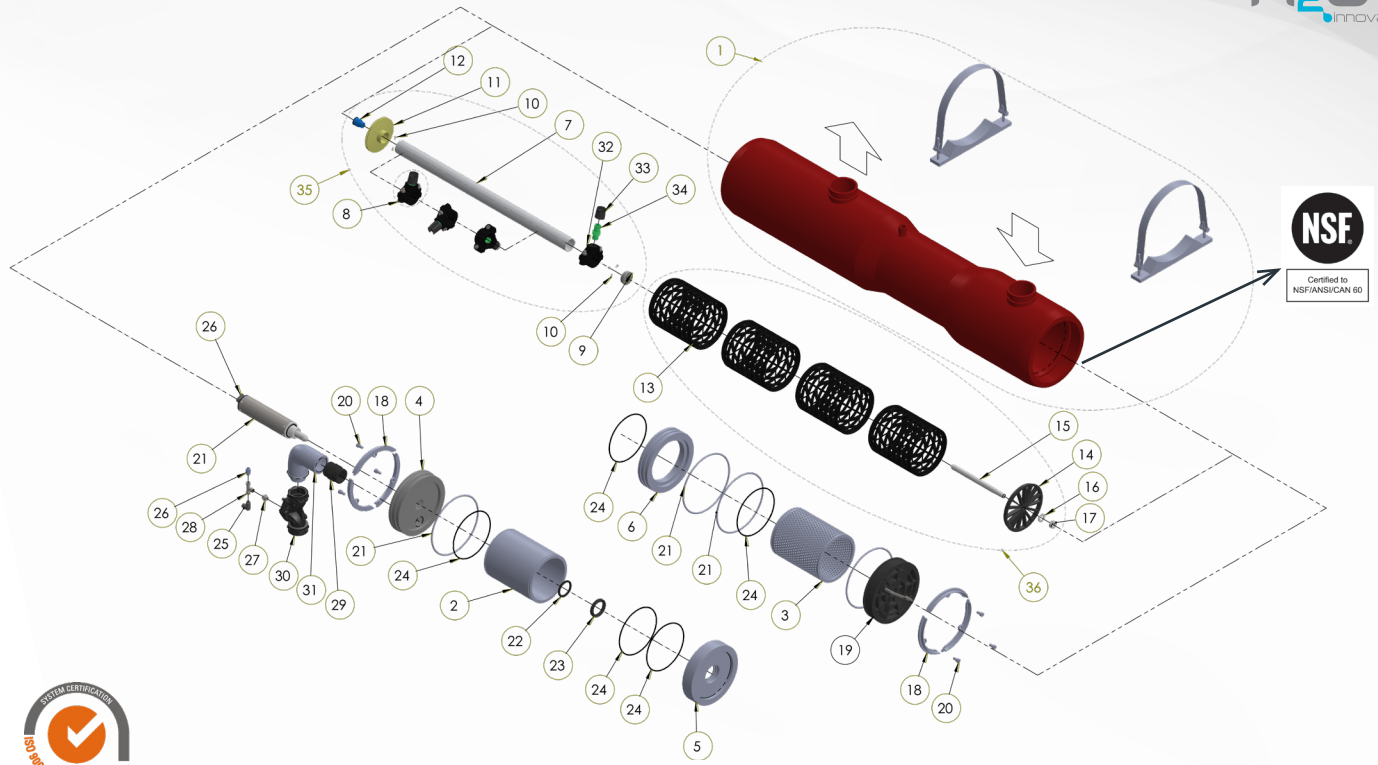

DESCRIPTION	Code / Units	
	EKOF3S / EKOF4S	EKOFW3S / EKOFW4S
	Irrigation	Seawater
1 Full housing	CCFRP160 x 1	CCFRP160 x 1
2 Drain chamber	CDFRP160 x 1	CDFRP160 x 1
3 Prefilter	CPFFRP160 x 1	CPFFRP160 x 1
4 Drainage plate	TDFRP160 x 1	TDFRP160 x 1
5 Drain chamber partition plate	TSCDFRP160 x 1	TSCDFRP160 x 1
6 Pre-filter to cartridge separator plate	TSPFFRP160 x 1	TSPFFRP160 x 1
7 I2V4T mechanism tube	TMI2H4FRP x 1*	TMI2H4FRPSD x 1*
8 Short complete nozzle with brush	CCBHRC x 4	CCBHRC x 4
9 Ø 16 Through cover scanner	MITP x 1	MITP x 1
10 3,5 x 9,5 DIN 7981 Stainless steel screw	T3595 x 5	T3595 x 5
11 Scanner turbine	TEFRP160 x 1	TEFRP160 x 1
12 Turbine plug	TCTFRP160 x 1	TCTFRP160 x 1
13 Ø 144 176 0,189 Cartridge injected section	T14P176 x 4	T14P176 x 4
14 Centering disc of the cartridge injected D144. Thread M14	DC14 x 1	DC14 x 1
15 Shaft of the cartridge centering Ø144	EJCCEK14 x 1*	EJCCEK14SD x 1*
16 Washer M14	AR14 x 1	AR14 x 1
17 Nut M14	TM14 x 1	TM14 x 1
18 Clip for side cover locking	MLCTL x 6	MLCTL x 6
19 Prefilter tape	TPFRP160 x 1	TPFRP160 x 1
20 DIN912 M8X15	T912M08015 x 6	T912M08015 x 6
21 Hydraulic cylinder	BOTE EK8 x 1*	BOTE EK8SD x 1*
22 Bearing	CASEKI x 1	CASEKI x 1
23 Seal Øi 44; Øe 60	REAM x 1	REAM x 1
24 O-ring 154.5 x 4	JT1544 x 1	JT1544 x 1
25 Swivel device 417 - tube 8 - 1/8" M thread	B417818 x 2	B417818 x 2
26 Straight fitting 8/6-1/8 - 1,2mm	B113 x 1	B113 x 1
27 Reducing fitting N 1/8-1/4 male x male	B245 x 1	B245 x 1
28 Device TH1/8	B400 x 1	B400 x 1
29 Threaded plug PP 1.5"	MRDPP112 x 1	MRDPP112 x 1
30 1.5" valve	VH112P x 1	VH112P x 1
31 Plastic device 90 1 1/2 male-female	CP112 x 1	CP112 x 1
32 Machined threaded nozzle collar 3/4P	CBHR34M x 1*	CBHR34MSD x 1*
33 Short threaded nozzle 3/4P	BHRC34 x 1	BHRC34 x 1
34 Threaded hydraulic nozzle brush	CPBH x 1	CPBH x 1
35 Full suction scanner I2V4	MI2V4T x 1	MI2V4T x 1
36 Cartridge 0,190MM	I2V4 x 1	I2V4 x 1

\* Parts adapted to seawater.